

We reserve all rights to this drawing, to any patents or patent registrations related hereto, and to the duplication, retransmission by third parties and misc. use. Any use of this drawing is not permitted without the written consent of STABILUS.

Intended for internal use and customer

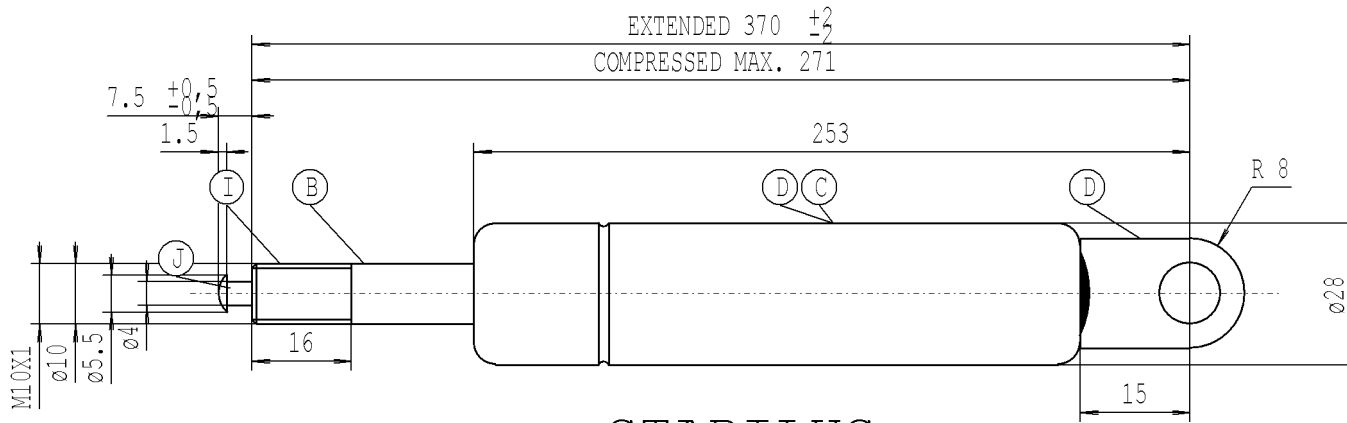

STABILUS BLOC-O-LIFT

NICHT OEFFNEN HOHER DRUCK
DO NOT OPEN HIGH PRESSURE
STABILUS STANDARD

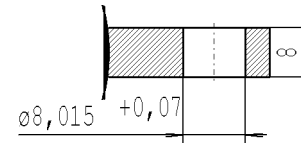

- the Gas Spring must not be mechanically modified or damaged.
- The warning label must not be removed or obscured.
- Compression and extension forces measured acc. to STAB-Spec. 10009033
- Spring test with piston rod downwards

- Protect piston rod from dirt, paint and damage
- Disposal acc. to STAB-Spec.10009375
- Drawing not true-to-scale
- Locking force at +20° C
in extension 9500 N
in compression 1000 N
- release-force of valve acc. to STAB-Spec. 10005233
- Observe installation instructions according to STAB-Spec. 10005593
- Permissible operating temperature range -30°C to +80°C
- To release:
press dia. pin by min. 2.5 mm
- Locking:
release the pin completely
- Installation: position any as required
- Press release max. 6.0 mm

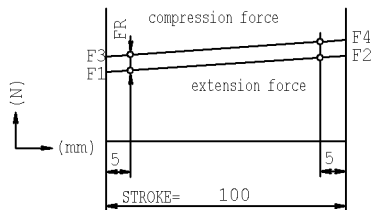

$$FR_{max} = F3 - F1$$

$$X = F2 / F1 = 1,24$$

Nozzle $\varnothing 0.9$

Forces (statically measured)

F1 (N)	F4 max (N)	FR max (N)
extension force 300 ±40	compression force 520	friction 80

- B Nislide black
- C print white
- D black painted
- I max. tightening torque: 25 Nm
- J bonderized

CHANGE	NEW	GT / Serie	UEBERARBEITUNG	KORR. F4 max	ROLLSCHLIESSEN
	OLD	NB / Versuch	%	%	BOST
	CHG. NO.	%	2430/93	2881/93	559313
	NAME	04.11.91 G.Stein	21.10.93 VO	26.11.93 VO	06.09.07 SCHNASS
NO.	1	2	3	4	

DIMENSIONS WITH-
OUT TOLERANCE

BLOC-O-LIFT

+/-1

06 21 1024 20 100

Unregistered Copy

Print-out is not subject to the modification service

STABILUS

Modifications in favour of technical process reserved

DRAWING		CHECKED	
DATE	31.10.1991	NAME	G.Stein
Document No. 10003894			

732095

E